

XEF-1RR

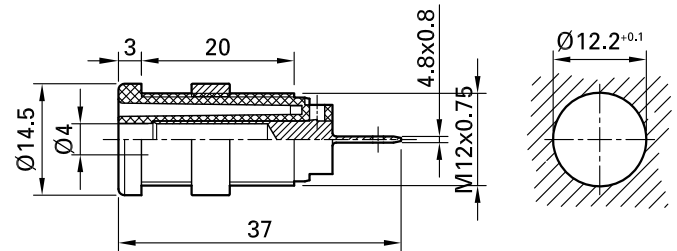

Item number 66.9854-*

Insulated, rigid, Ø 4 mm, accepting spring-loaded Ø 4 mm plugs with rigid insulating sleeve. Machined brass. The sockets are screwed into pre-drilled panels of plastic, metal, etc. Connection: Flat connecting tab 4.8 mm x 0.8 mm.

Technical data	
Diameter of plug system	4 mm
Rated Values	1000 V, CAT IV, 24 A
Surface treatment electrical contact	Ni
Base material electrical contact	CuZn
Colours *	21 22 23
Thread	M12x0,75
Test accessory acc. to	IEC EN 61010-2-030
Supplied assembly material	MUR/M12x0,75
Approvals	UR
Remarks	Accessories: Flat connecting receptacle FSH4,8x0,8; Tube spanner SS2; Tube spanner SS425