

SEB4-G

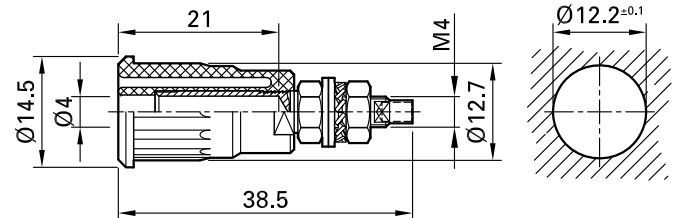

Item number 23.3140-*

Insulated, rigid, Ø 4 mm, accepting spring-loaded Ø 4 mm plugs with rigid insulating sleeve. Machined brass. The socket is pressed into pre-drilled panels of plastic, metal, etc. Connection: Threaded bolt M4 and soldering hole

Technical data

Diameter of plug system	4 mm
Rated Values	1000 V, CAT III, 24 A
Surface treatment electrical contact	Au
Base material electrical contact	CuZn
Colours *	20 21 22 23 24 25 27 28
Test accessory acc. to	IEC EN 61010-2-030
Supplied assembly material	2x MU0,8D/M4; 2x U/M4; FS/M4
Material insulating part	PA
Approvals	UR
Remarks	Accessories: Press-in tool MB4-S