

CombiTac Standard DIN housings

CombiTacline | Industrial Connectors



INTRODUCTION

Standard DIN housings

Aluminum DIN housings size 2, 3, 4 are designed to serve general industrial and railway applications.

Available in grey and white color. Further colors available upon request.

Features:

- Up to 10,000 mating cycles
- IP65 and IP67 in mated condition
- 6 coding possibilities
- Quick and easy replacement of sealing
- Resistance to shock and vibrations
- IP2X during connecting/disconnecting process when using protective walls
- Ergonomic locking mechanism

Benefits:

- Minimum service costs
- Added user safety
- Low maintenance costs
- Reliable solution
- Easy handling

Coupler hoods / Surface and pedestal mount housings



Coupler hoods

Can be used with a surface or pedestal mount housing. Available with side or top cable entry, with or without protective wall.

Surface and pedestal mount housings

Both types are used with coupler hoods. The choice of mount housing depends on the cable entry type. Available with or without protective wall or cover.

Accessories

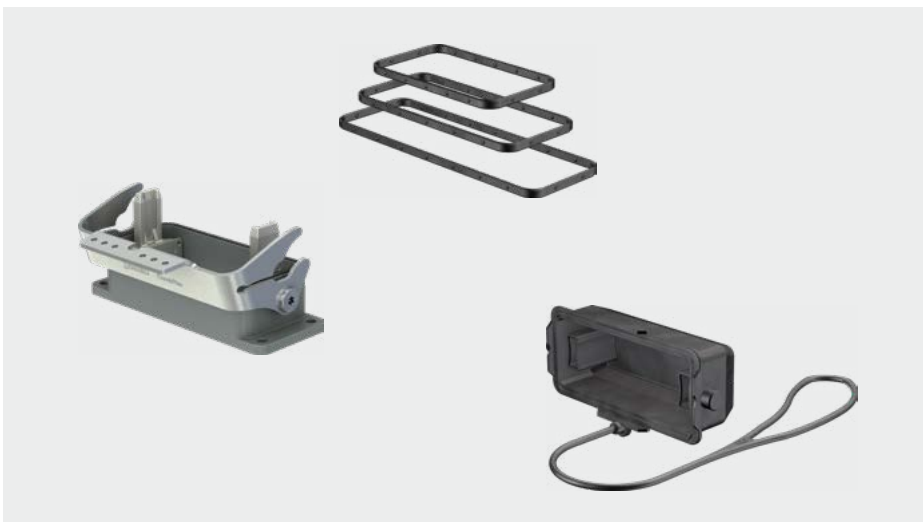

Park stations

- For parking coupler hoods when not in use

Replacement seals

- Available upon request

Protective caps

- Protective caps for mounting on all surface and pedestal mount housings and coupler hoods

TECHNICAL DATA

Technical data DIN housings

Technical data	
Housing material	Aluminum
Color	Grey RAL7012 White RAL9003
Seal material	NBR
Locking mechanism material	Stainless steel
Mating cycles	10,000 ¹⁾
Temperature range	-40 °C to +125 °C short-term operation -40 °C to +90 °C continuous operation
Degree of protection	IP65 and IP67 in mated condition IP2X with protective wall during mating process
Vibrations and shock IEC 62847:216	Vibrations 3.1g/5 – 250 Hz (IEC 61373 Category 1, Class B) Shock 30 g / 18 ms (IEC 61373 Category 1, Class B)

Note:

For coding, spare parts and protective grounding of DIN housings, see **CombiTac** main catalog.

For further CombiTac housings
please see CombiTac main catalog

¹⁾ Follow maintenance instructions according to MA213

COUPLER HOOD

Coupler hood

Coupler hoods can be combined with surface or pedestal mount housing. Available with side or top cable entry.

Note:

For white housing please add the color code number 29. E.g. 33.2362-**29**. Further colors available upon request.

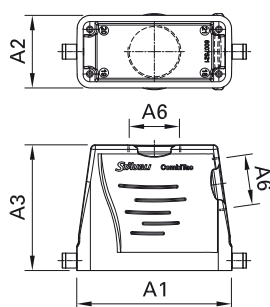

Size	Order No.	Type	Cable entry		Sizes (mm)				Standard color
			Top	Side	A1	A2	A3	A6	
2	33.2362	CT-CH2-T	x		73.8	43.9	70	M32	29
	33.2402	CT-CH2-S		x					
3	33.2363	CT-CH3-T	x		93.8	43.9	76	M32	29
	33.2403	CT-CH3-S		x					
4	33.2364	CT-CH4-T	x		120.8	43.9	78	M32	29
	33.2404	CT-CH4-S		x					

Coupler hood with protective wall, IP2X

Coupler hoods with protective walls offer additional damage protection to contacts along with IP2X protection during the

connecting/disconnecting process. Protective walls are in black.

Note:

For white housing please add the color code number 29. E.g. 33.2362-29. Further colors available upon request.

CT-CH...PW

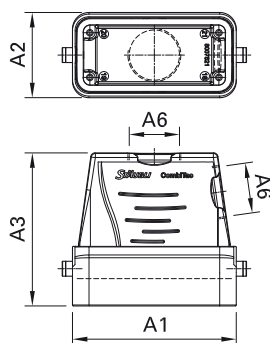

CT-CH...PW-PC

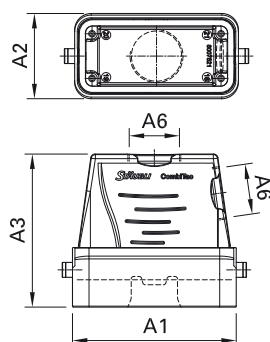

Size	Order No.	Type	Cable entry		Sizes (mm)				Standard color
			Top	Side	A1	A2	A3	A6	
2	33.2912	CT-CH2-T/PW	x		78.5	51.5	86.5	M32	29
	33.2952	CT-CH2-S/PW		x					
3	33.2913	CT-CH3-T/PW	x		99	51.5	92.5	M32	29
	33.2953	CT-CH3-S/PW		x					
4	33.2914	CT-CH4-T/PW	x		125.2	51.5	94.5	M32	29
	33.2954	CT-CH4-S/PW		x					

for use with housings that include protective covers

2	33.2932	CT-CH2-T/PW-PC	x		78.5	51.5	86.5	M32	29
	33.2972	CT-CH2-S/PW-PC		x					
3	33.2933	CT-CH3-T/PW-PC	x		99	51.5	92.5	M32	29
	33.2973	CT-CH3-S/PW-PC		x					
4	33.2934	CT-CH4-T/PW-PC	x		125.2	51.5	94.5	M32	29
	33.2974	CT-CH4-S/PW-PC		x					

MOUNT HOUSING

Surface mount housing

Surface mount housings are used for bottom cable entry. They are combined with coupler hoods and are available with or

without protective wall or cover. Protective walls are in black.

Note:

For white housing please add the color code number 29. E.g. 33.2362-**29**. Further colors available upon request.

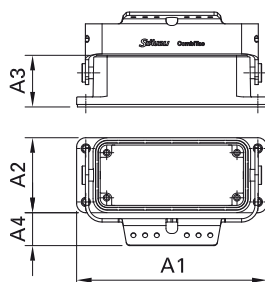

CT-SM...PW

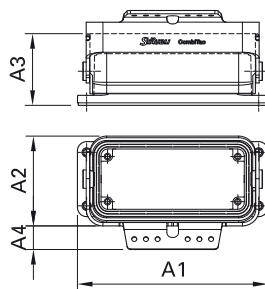

CT-SM...PC

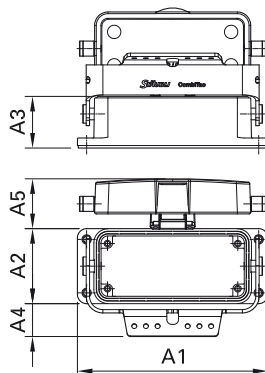

Size	Order No.	Type	Protective cover	Protective wall	Sizes (mm)					Standard color
					A1	A2	A3	A4	A5	
2	33.2302	CT-SM2			94	44.9	28.5	32.9	29.8	29
	33.2852	CT-SM2/PW		x						
	33.2332	CT-SM2-PC	x							
3	33.2303	CT-SM3			114	44.9	28.5	32.9		29
	33.2853	CT-SM3/PW		x						
	33.2333	CT-SM3-PC	x							
4	33.2304	CT-SM4			141	44.9	28.5	32.9		29
	33.2854	CT-SM4/PW		x						
	33.2334	CT-SM4-PC	x							

Pedestal mount housing

Pedestal mount housings are used for left or/and right side cable entry. They are combined with coupler hoods and are available

with or without protective wall or cover. Protective walls are black.

Note:

For white housing please add the color code number 29. E.g. 33.2362-**29**. Further colors available upon request.

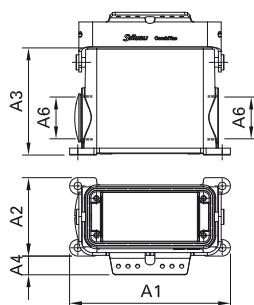

CT-PM...PW

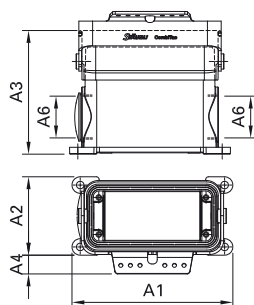

CT-PM...PC

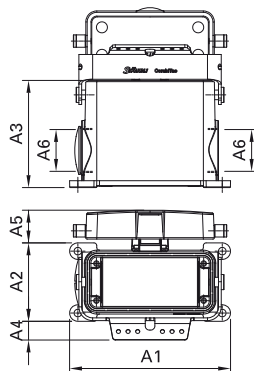

Size	Order No.	Type	Protective cover	Protective wall	Sizes (mm)						Standard color
					A1	A2	A3	A4	A5	A6	
2	33.2462	CT-PM2					74				29
	33.2872	CT-PM2/PW		x	94	57	86.9	26.9	23.8	M32	
	33.2702	CT-PM2-PC	x				74				
3	33.2463	CT-PM3					77				29
	33.2873	CT-PM3/PW		x	117	57	90	26.9	23.8	M32	
	33.2703	CT-PM3-PC	x				77				
4	33.2464	CT-PM4					79				29
	33.2874	CT-PM4/PW		x	144	57	92	26.9	23.8	M32	
	33.2704	CT-PM4-PC	x				79				

ACCESSORIES

Park stations

Used for parking coupler hoods when they are not connected to mount housings.

Note:

For white housing please add the color code number 29. E.g. 33.2362-**29**. Further colors available upon request.

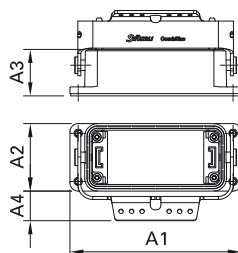

CT-PS...SM/S

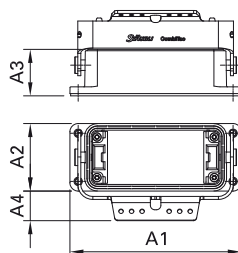

CT-PS...PC-SM/S

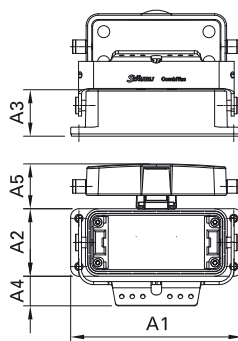

Size	Order No.	Type	Pin end pieces	Socket end pieces	Protective cover	Sizes (mm)					Standard color
						A1	A2	A3	A4	A5	
2	33.1802	CT-PS2-SM/P	x		x	94	44.9	28.5	32.9	29.8	29
	33.1812	CT-PS2-SM/S		x							
	33.1832	CT-PS2/PC-SM/S		x							
3	33.1803	CT-PS3-SM/P	x		x	114	44.9	28.5	32.9	29.8	29
	33.1813	CT-PS3-SM/S		x							
	33.1833	CT-PS3/PC-SM/S		x							
4	33.1804	CT-PS4-SM/P	x		x	141	44.9	28.5	32.9	29.8	29
	33.1814	CT-PS4-SM/S		x							
	33.1834	CT-PS4/PC-SM/S		x							

Replacement seals

Housing replacement seals from NBR material can be ordered as replacements.



Size	Order No.	Type
2	33.2782	CT-DDI-SM2
3	33.2783	CT-DDI-SM3
4	33.2784	CT-DDI-SM4

Protective cap

For mounting on all surface and pedestal mount housings or coupler hood with pin end pieces. Protective cap suitable for all pin lengths.

Protective cap material: PA.



Size	Order No.	Type	for metal housing
2	33.1302	CT-SD-AG2-L/FSCH	x
3	33.1303	CT-SD-AG3-L/FSCH	x
4	33.1304	CT-SD-AG4-L/FSCH	x

Notes

Notes



■ Stäubli Units ○ Agents

Global presence of the Stäubli Group

www.staubli.com